



MMCX Connectors

Specifications	10
Flexible Cable	11
PCB Mount	13

Other Information

Assembly Instructions	176
Cable Assembly	166
Cable Information	168
Numerical Index	184

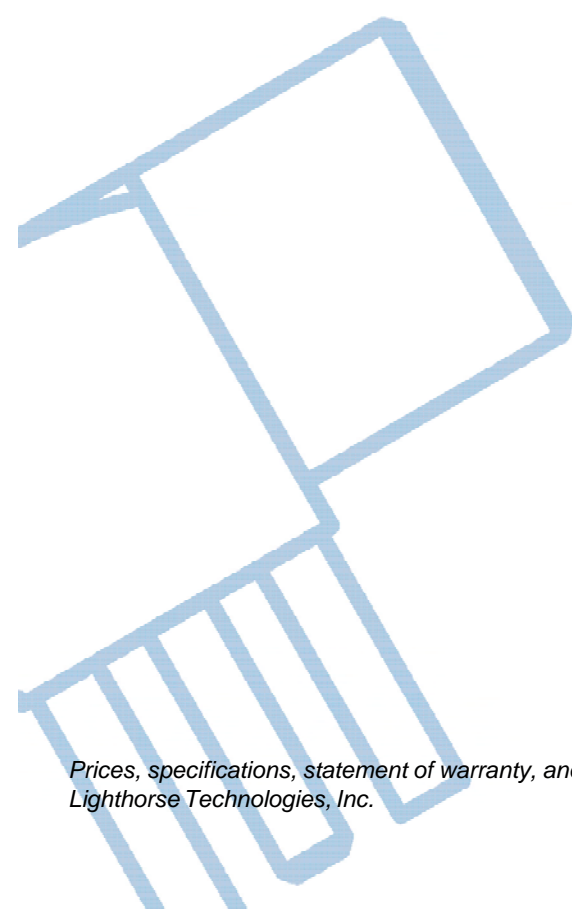
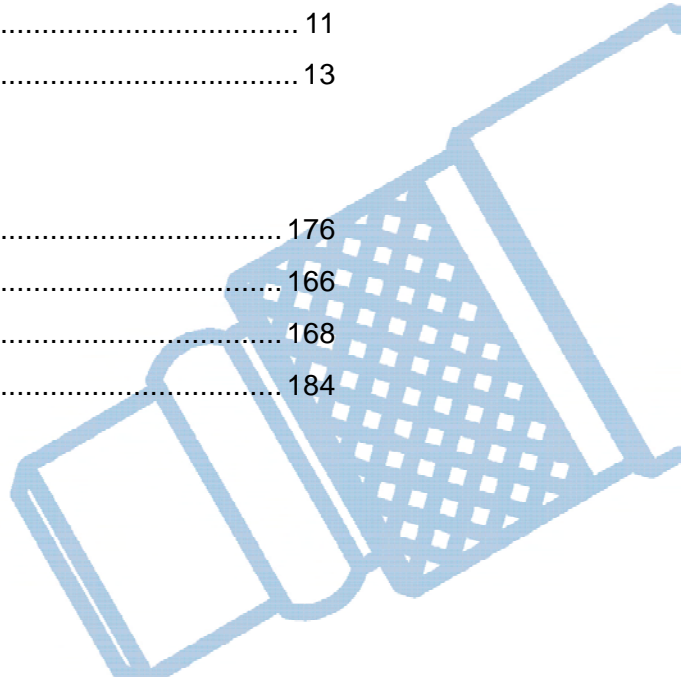

Prices, specifications, statement of warranty, and other terms and conditions are subject to change without notice by Lighthouse Technologies, Inc.



MMCX microminiature connectors are suitable for 50 ohm applications and provide repeatable electronic performance from DC to 6 GHz. The snap-on mating design offers low RF leakage and ease of assembly in dense packaging layouts. The MMCX series is one of the smallest Lighthouse Technologies currently offers, allowing for usage in space critical applications. The connectors are lightweight, compact and reliable.

Typical applications for MMCX connectors are PCMCIA cards and other small hand-held communication devices.

Interface Mating Dimensions

PLUG

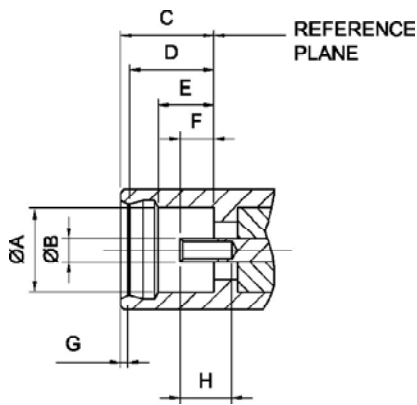

Letter	Minimum	Maximum
A	-	2.40
B	1.58	1.62
C	2.70	-
D	0.00	0.25
E	1.45	-
F	0.70 nom	
G	-	-
H	-	-
I	0.38	0.38

DIMENSIONS ARE IN MILLIMETERS

JACK

Letter	Minimum	Maximum
A	2.41	-
B	0.70 nom	
C	2.60	-
D	2.30	2.34
E	1.57	1.63
F	0.90	1.20
G	-	0.23
H	1.40	-

DIMENSIONS ARE IN MILLIMETERS

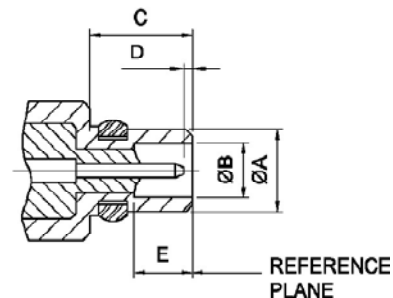
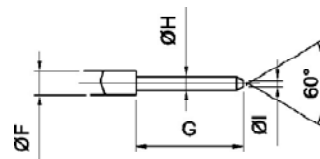



ELECTRICAL RATINGS

Impedance	50 ohm		
Frequency Range	0-6 GHz		
VSWR		<i>Straight</i>	<i>Right Angle</i>
	RG-174,188,316	1.20 max	1.25 max
	RG-178,196	1.20 max	1.25 max
Voltage Rating (min)	170 VRMS at sea level		
Dielectric Withstanding Voltage	500 VRMS minimum		
Contact Resistance		<i>Center Contact</i>	<i>Outer Contact</i>
		10.0 mΩ max	5.0 mΩ max

MECHANICAL RATINGS

Mating	Snap-on coupling	
Durability	500 matings	
Engagement/Disengagement Force	8 lbs. max engagement/1.4 lbs. min disengagement	
Cable Retention	RG-174, 188, 316	RG-178, 196
	12.1 lbs. minimum	7.3 lbs. minimum

ENVIRONMENTAL RATINGS

Temperature Range	-65°C to + 165°C
Thermal Shock	MIL-STD-202F, Method 1017G, Condition A
Vibration	MIL-STD-202F, Method 204D, Condition A
Corrosion	MIL-STD-202F, Method 101D, Condition A
Mechanical Shock	MIL-STD-202F, Method 213B, Condition A

MATERIALS

		<i>Material</i>	<i>Plating</i>
Connector Body		Brass per QQ-B-626	Gold/Nickel
Center Contact	<i>Male</i>	Brass per QQ-B-626	Gold
	<i>Female</i>	Beryllium Copper per QQ-C-530	Gold
Insulator		Teflon	None
Crimp Ferrule		Annealed Copper per WW-T-799	Same as body



Straight Crimp Plug



Part Number	Cable Type	Dimension	
LTI-MCSM11GT-XXX	316,174,188;Q1,D316	A: 1.7	B: 2.7
LTI-MCSM11GT-XXX	178,196	A: 1.0	B: 1.7

TO CREATE COMPLETE PART NUMBER: Fill in Cable Type where XXX is.

See Part Numbering Chart on page 3 for more info.

Nickel plated parts (LTI-MCSM11NT-XXX) available. Call for min order reqs.

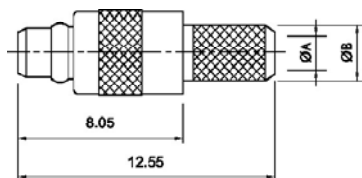

ASSEMBLY INST.: Page 176
Recommended Stripping DIMs:
Page 172, Line 3

Right Angle Crimp Plug

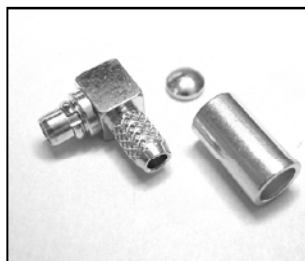

Part Number	Cable Type	Dimension	
LTI-MCLM11GT-XXX	316,174,188;Q1,D316	A: 1.7	B: 2.7
LTI-MCLM11GT-XXX	178,196	A: 1.0	B: 1.7

TO CREATE COMPLETE PART NUMBER: Fill in Cable Type where XXX is.

See Part Numbering Chart on page 3 for more info.

Nickel plated parts (LTI-MCLM11NT-XXX) available. Call for min order reqs.

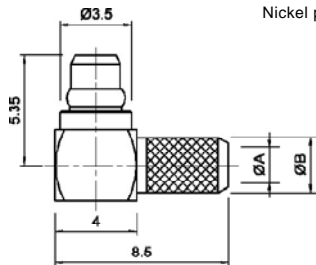

ASSEMBLY INST.: Page 177
Recommended Stripping DIMs:
Page 172, Line 4

Straight Crimp Jack

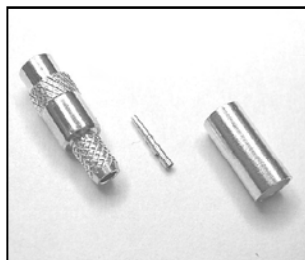

Part Number	Cable Type	Dimension	
LTI-MCSF11GT-XXX	316,174,188;Q1,D316	A: 1.7	B: 2.7
LTI-MCSF11GT-XXX	178,196	A: 1.0	B: 1.7

TO CREATE COMPLETE PART NUMBER: Fill in Cable Type where XXX is.

See Part Numbering Chart on page 3 for more info.

Nickel plated parts (LTI-MCSF11NT-XXX) available. Call for min order reqs.

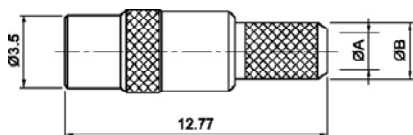

ASSEMBLY INST.: Page 176
Recommended Stripping DIMs:
Page 172, Line 3

Right Angle Crimp Jack



Part Number	Cable Type	Dimension	
LTI-MCLF11GT-XXX	316,174,188;Q1,D316	A: 1.7	B: 2.7
LTI-MCLF11GT-XXX	178,196	A: 1.0	B: 1.7

TO CREATE COMPLETE PART NUMBER: Fill in Cable Type where XXX is.

See Part Numbering Chart on page 3 for more info.

Nickel plated parts (LTI-MCLF11NT-XXX) available. Call for min order reqs.

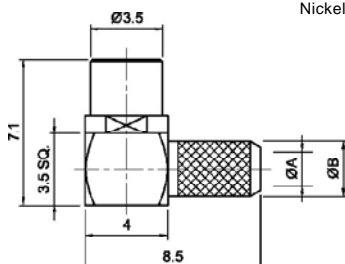

ASSEMBLY INST.: Page 177
Recommended Stripping DIMs:
Page 172, Line 4



Straight Solder Plug for Semi-Rigid Cable

Part Number	Cable Type	Dimension	
LTI-MCSM31GT-086	Semi-Rigid .086"	A: 2.3	B: 3.2
LTI-MCSM31GT-047	Semi-Rigid .047"	A: 1.3	B: 2.2

Nickel plated parts (LTI-MCSM31NT-XXX) available. Call for min order reqs.

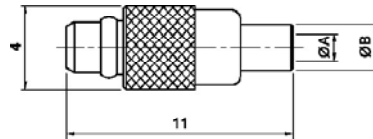
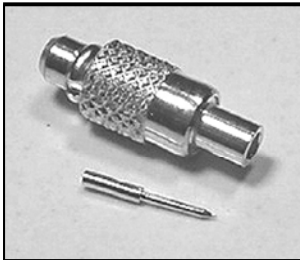

ASSEMBLY INST.: Page 180
Recommended Stripping DIMS:
Page 173, Line 4

Right Angle Solder Plug for Semi-Rigid Cable

Part Number	Cable Type	Dimension	
LTI-MCLM31GT-086	Semi-Rigid .086"	A: 2.3	B: 3.2
LTI-MCLM31GT-047	Semi-Rigid .047"	A: 1.3	B: 2.2

Nickel plated parts (LTI-MCLM31NT-XXX) available. Call for min order reqs.

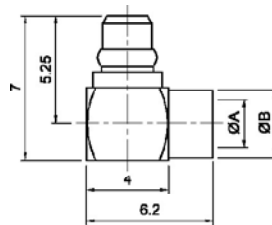

ASSEMBLY INST.: Page 181
Recommended Stripping DIMS:
Page 173, Line 4

2-Hole Panel Mount Jack With Solder Post Termination

Part Number
LTI-MCSF92NFGT

Nickel plated parts (LTI-MCSF92NFNT) available. Call for min order reqs.

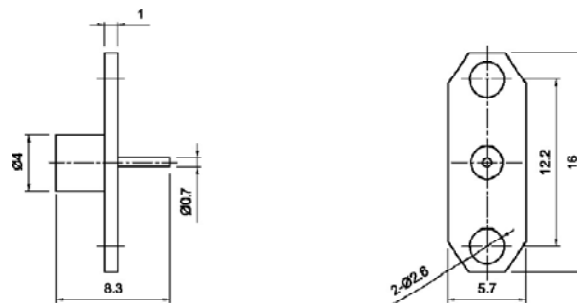

2-Hole Panel Mount Jack With Solder Post and Extended Dielectric

Part Number
LTI-MCSF92DNFGT

Nickel plated parts (LTI-MCSF92DNFNT) available. Call for min order reqs.

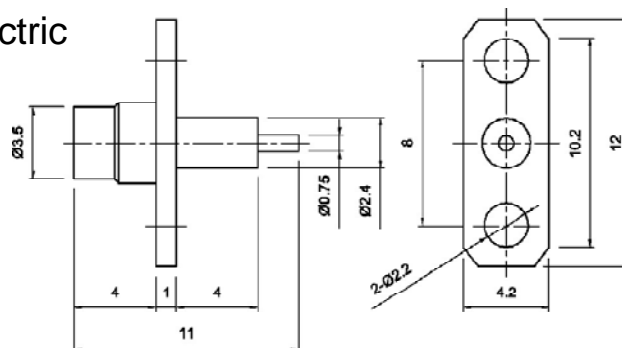



Bulkhead Crimp Jack

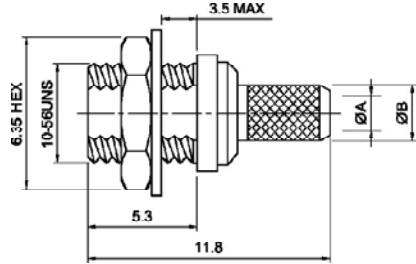
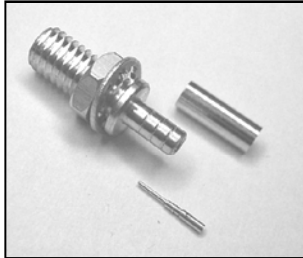

Part Number	Cable Type	M.H.	Dimension	
LTI-MCSF13RGT-XXX	316,174,188,Q1,D316	4	A: 1.6	B: 2.35
LTI-MCSF13RGT-XXX	178,196	4	A: 1.0	B: 1.7

TO CREATE COMPLETE PART NUMBER: Fill in Cable Type where XXX is.
See Part Numbering Chart on page 3 for more info.
Nickel plated parts (LTI-MCSF13RNT-XXX) available. Call for min order reqs.

MOUNTING HOLE (M.H.): Page 174
ASSEMBLY INST.: Page 176
Recommended Stripping DIMs:
Page 172, Line 40

Bulkhead Solder Jack for Semi-Rigid Cable

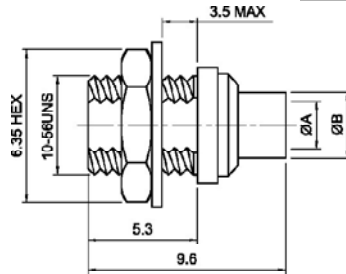
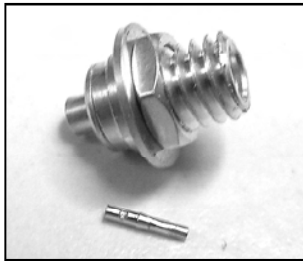

Part Number	Cable Type	M.H.	Dimension	
LTI-MCSF33RGT-086	Semi-Rigid .086"	4	A: 2.3	B: 3.2
LTI-MCSF33RGT-047	Semi-Rigid .047"	4	A: 1.3	B: 2.2

Nickel plated parts (LTI-MCSF33RNT-XXX) available. Call for min order reqs.

MOUNTING HOLE (M.H.): Page 174
ASSEMBLY INST.: Page 180
Recommended Stripping DIMs:
Page 172, Line 2

Vertical PCB Thru Hole Plug

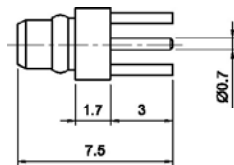

Part Number	M.H.
LTI-MCSM54GT	20

Nickel plated parts (LTI-MCSM54NT) available. Call for min order reqs.

MOUNTING HOLE (M.H.): Page 174

Right Angle PCB Thru Hole Plug

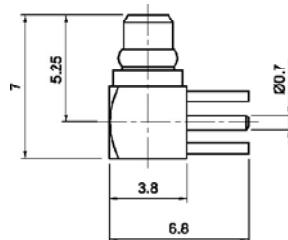
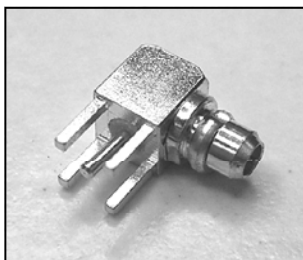

Part Number	M.H.
LTI-MCLM54GT	20

Nickel plated parts (LTI-MCLM54NT) available. Call for min order reqs.

MOUNTING HOLE (M.H.): Page 174



Vertical PCB Thru Hole Jack

Part Number	M.H.
LTI-MCSF54GT	20

Nickel plated parts (LTI-MCSF54NT) available. Call for min order reqs.

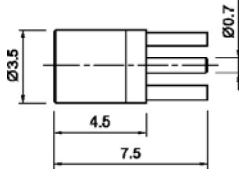
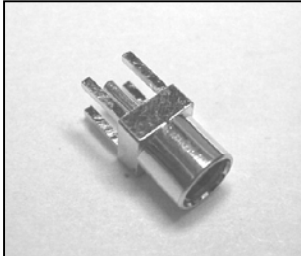

MOUNTING HOLE (M.H.): Page 174

Vertical Thru Hole Jack, 2 Legs

Part Number	M.H.
LTI-MCSF54GT-2	18

Nickel plated parts (LTI-MCSF54NT-2) available. Call for min order reqs.

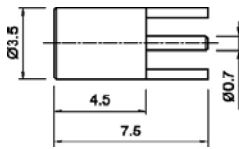
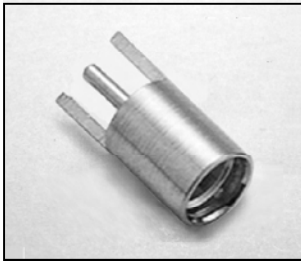

MOUNTING HOLE (M.H.): Page 174

Right Angle PCB Thru Hole Jack

Part Number	M.H.
LTI-MCLF54GT	20

Nickel plated parts (LTI-MCLF54NT) available. Call for min order reqs.

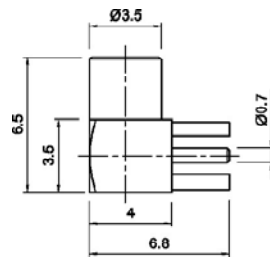
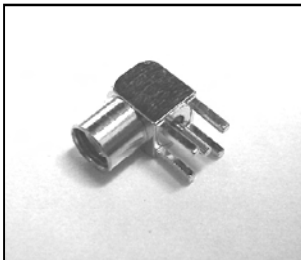

MOUNTING HOLE (M.H.): Page 174

Edge Mount Plug, Short

Part Number	M.H.
LTI-MCSM56ZGT	44

Nickel plated parts (LTI-MCSM56ZNT) available. Call for min order reqs.

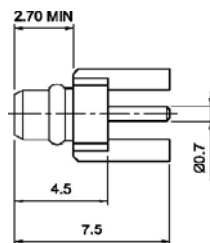
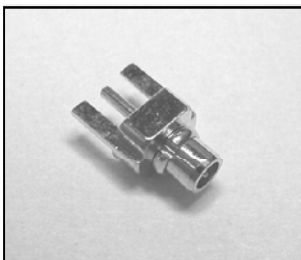

MOUNTING HOLE (M.H.): Page 175



Edge Mount Plug

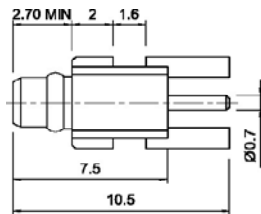
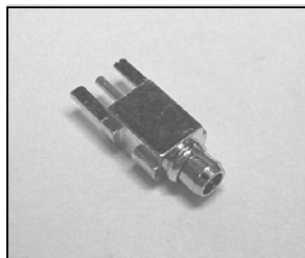

Part Number	M.H.
LTI-MCSM56GT	44

Nickel plated parts (LTI-MCSM56NT) available. Call for min order reqs.

MOUNTING HOLE (M.H.): Page 175

Edge Mount Jack

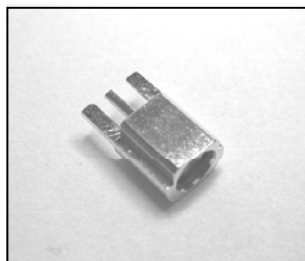

Part Number	M.H.
LTI-MCSF56GT	44

Nickel plated parts (LTI-MCSF56NT) available. Call for min order reqs.

MOUNTING HOLE (M.H.): Page 175

Edge Card Surface Mount Jack

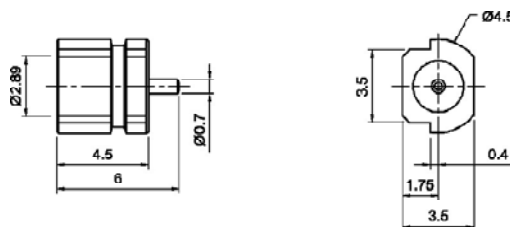
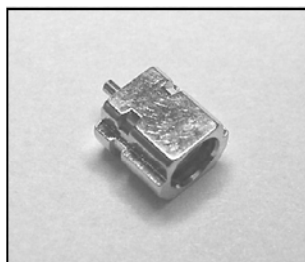

Part Number	M.H.
LTI-MCSF96GT	49

Nickel plated parts (LTI-MCSF96NT) available. Call for min order reqs.

MOUNTING HOLE (M.H.): Page 175

Surface Mount Jack

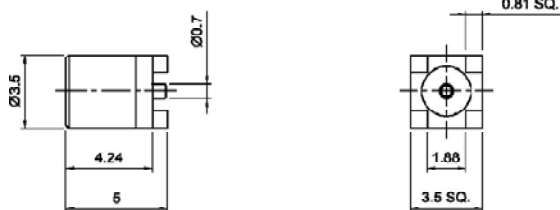
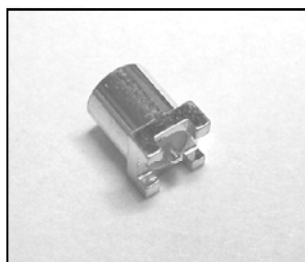

Part Number	M.H.
LTI-MCSF66GT	47

Nickel plated parts (LTI-MCSF66NT) available. Call for min order reqs.

MOUNTING HOLE (M.H.): Page 175