

<b>Tolerances</b> 1-20=+/-0.2 20-30=+/-0.3 30-40=+/-0.4 40-50=+/-0.5 50-100=+/-0.75 100-300=+/-1.5 Angles=+/-1 <b>Dimensions are in Millimeters</b>	Revisions	Approved	Date
	Description/Approved/Date	M.H.	08/13/99
		Checked	Date
	M.H.	8/13/99	
	Drawn	Date	
	K.R.E.	8/10/99	
	NOTES (plating thickness in micro-inches): 1. Per QQ-B-626 2. Per QQ-S-764 3. Per QQ-C-530 4. Per QQ-B-750 5. Per MIL-P-19468 6. Per ZZ-R-765 7. Per WW-T-799 8. Gold pl. 5 min. over nickel pl. 50 min. over copper strike 9. Nickel pl. 100 min. over copper strike 10. Per QQ-P-35 11. Gold pl. 30 min. over nickel pl. 50 min. over copper strike		

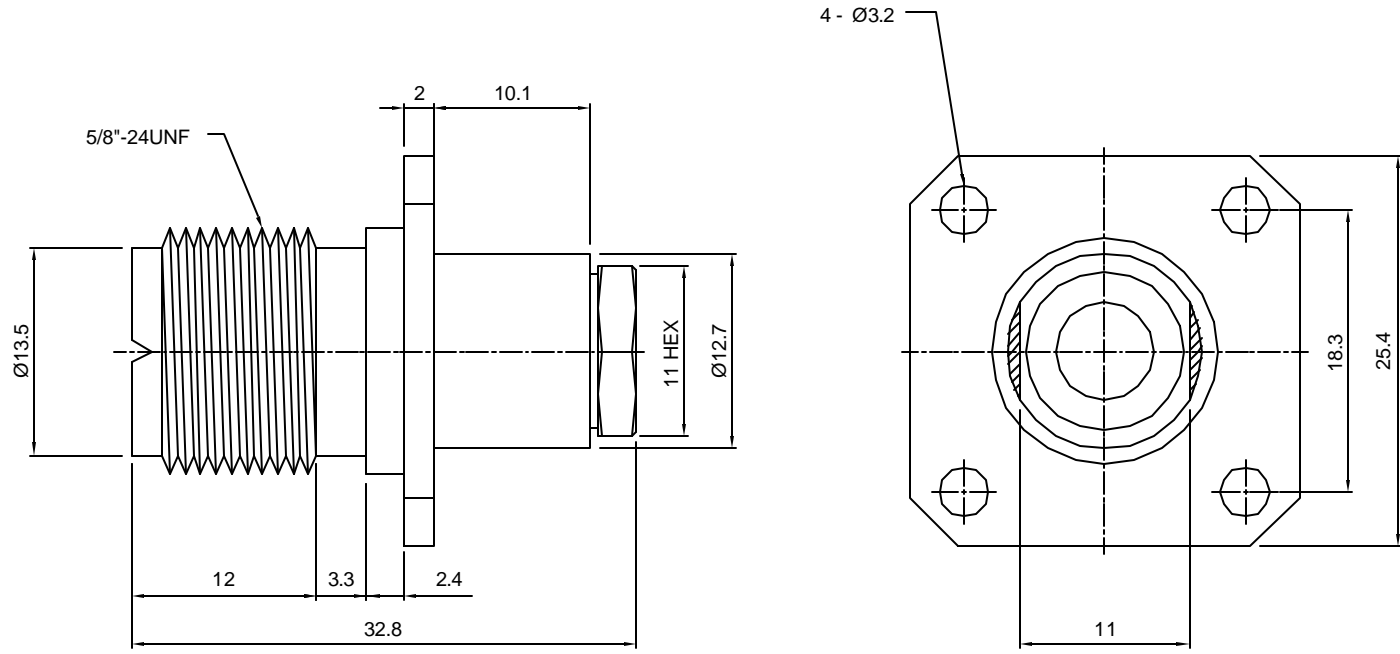

ITEM	MATERIAL	FINISH
Connector Body	Brass, Note 1	Nickel, Note 9
Center Contact: Female	Brass, Note 1	Gold, Note 11
Insulation	Delrin	None
Ferrule	--	--
Gasket	Silicone Rubber, Note 6	None
Hex Nut	Brass, Note 1	Same as body
Lock Washer	Brass, Note 1	Same as body

<b>Lighthouse Technologies, Inc.</b> 4907 Morena Boulevard, #1411 San Diego, California 92117		
Description		
UHF panel mount clamp type jack for RG-58 cable.		
Nickel plated brass body, delrin dielectric.		
Scale	Drawing No.	File Name
2:1	UHF/USF22	USF22